

# 小型拉杆C型 PULLER BOLT C TYPE [简体]

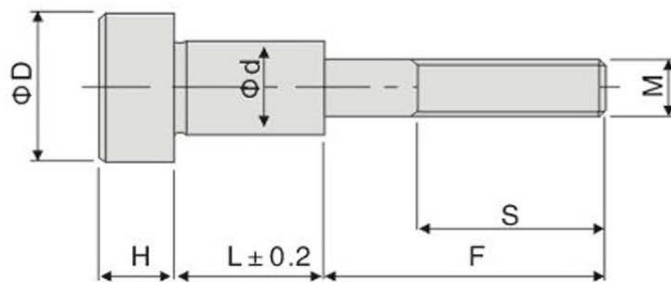
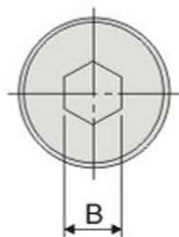

M材質	Hardness 硬度
SCM435	HRC22°~28°
	HV900°-1000°

Metric system(mm)

D 容許差		H 容許差		Catalog No.			M	S	B	L	F	
				Type	d	容許差 Tolerance						
16	0 -0.43	8	0 -0.36	JH030	10	0 -0.15	M6	18	6	16	22	
					13					21	27	
14	30											
18	0 -0.43	10	0 -0.36		JH030	16	0 -0.15	M8	24	8	19	35
						24					40	
15	35											
24	0 -0.52	14	0 -0.43	JH030		20	0 -0.20	M10	26	10	20	40
						30					45	
20	45											
28	0 -0.52	14	0 -0.43		JH030	25	0 -0.20	M12	30	14	30	50
						35					55	
31	60											
33	0 -0.62	18	0 -0.43	JH030		25	0 -0.20	M16	38	17	31	60
						41					65	

● Order: Catalog No. [d] \* [H] \* [L] \* [F]

2D下載

3D下載

返回索引