

導位固定塊 STRAIGHT BLOCK SET-PL TYPE [筒体]

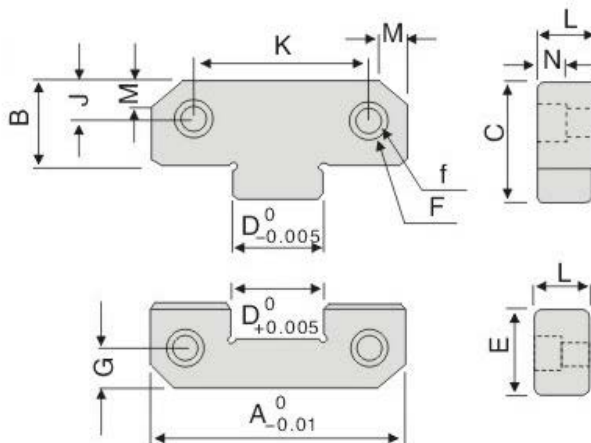

使用例

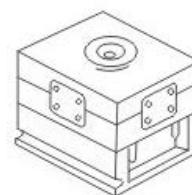

Material	Hardness 硬度	Heat Treatment 熱處理
YK30	HRC56°~60°	真空處理 Vacuumed

Metric system(mm)

Type	Product code	A	B	C	D	E	F	f	G	J	K	L	M	N
JH041	PL38	38	22	30	12	22	10.5	6.5	7	7	22	13	5	8
	PL50	50	21.5	30	17	21.5	10.5	6.5	11	11	34	16	5	8
	PL75	75	36	50	25	36	16.5	10.5	18	18	50	19	8	12
	PL100	100	45	65	35	45	16.5	10.5	22	22	70	19	10	12
	PL125	125	45	65	45	45	16.5	10.5	22	22	84	25	10	12

Inch

Type	Product code	A	B	C	D	E	F	f	G	J	K	L	M	N
JH042	PL1.5	1.5	0.87	1.18	0.50	0.87	0.433	0.276	0.281	0.437	0.938	0.620	0.19	0.3
	PL2.0	2.0	0.87	1.18	0.68	0.87	0.433	0.276	0.375	0.437	1.250	0.620	0.19	0.3
	PL3.0	3.0	1.36	1.91	1.00	1.37	0.590	0.413	0.688	0.688	2.250	0.745	0.38	0.45
	PL4.0	4.0	1.87	2.64	1.38	1.87	0.590	0.413	0.875	0.875	2.750	0.745	0.50	0.45
	PL5.0	5.0	1.87	2.64	1.75	1.87	0.788	0.555	0.875	0.875	3.500	1.120	0.50	0.6

● Order: Type

備注：圓面以外特殊規格可定制

2D下載

3D下載

返回索引